

Findings of Consistency- Detmold Property Acquisition GOV10-0009

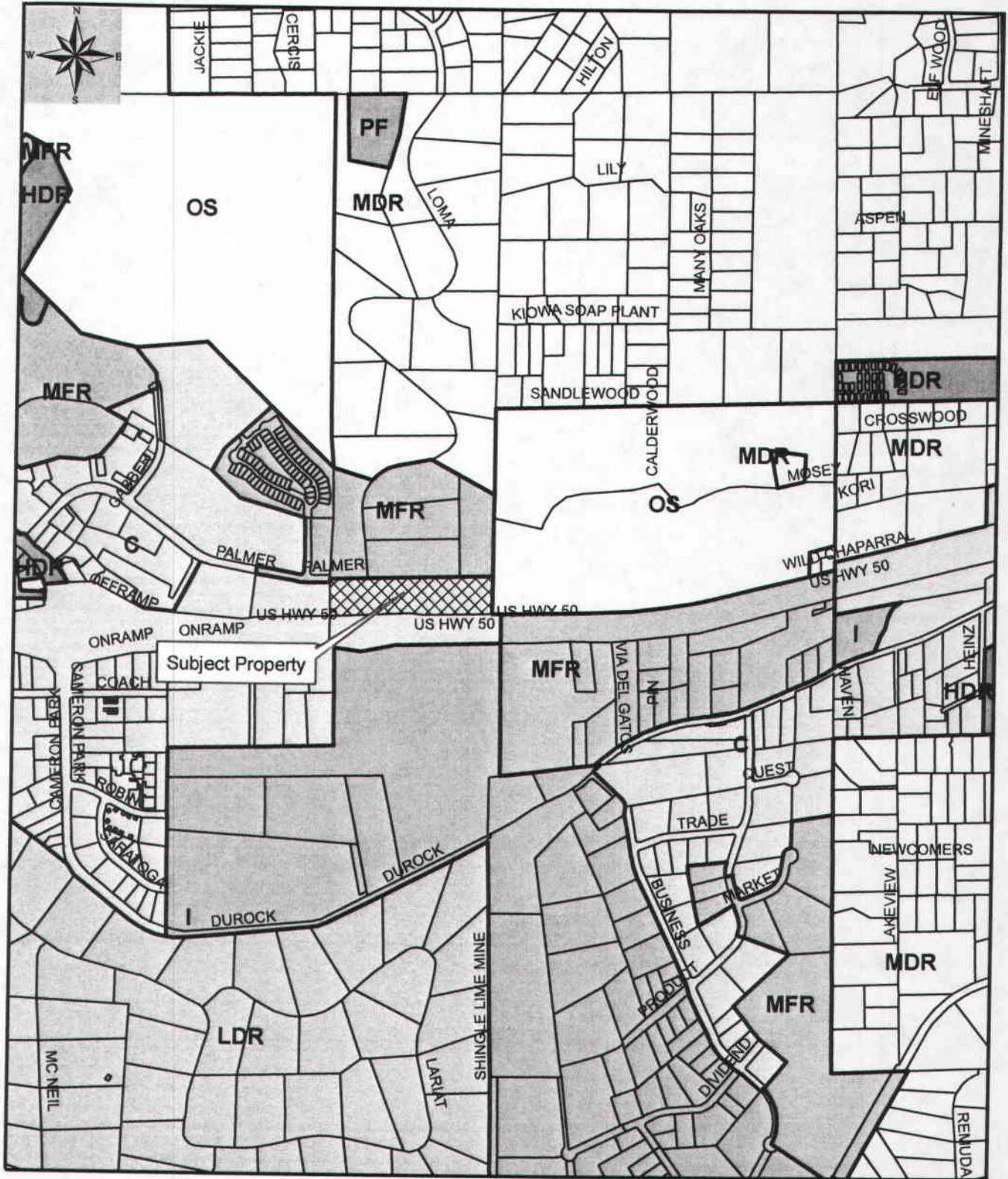

0 200 400 800 Feet

Map prepared by
M&P Planning
© Corral County
Development Services-Planning

Exhibit B- General Plan Land Use Map

Findings of Consistency- Detmold Property Acquisition GOV10-0009

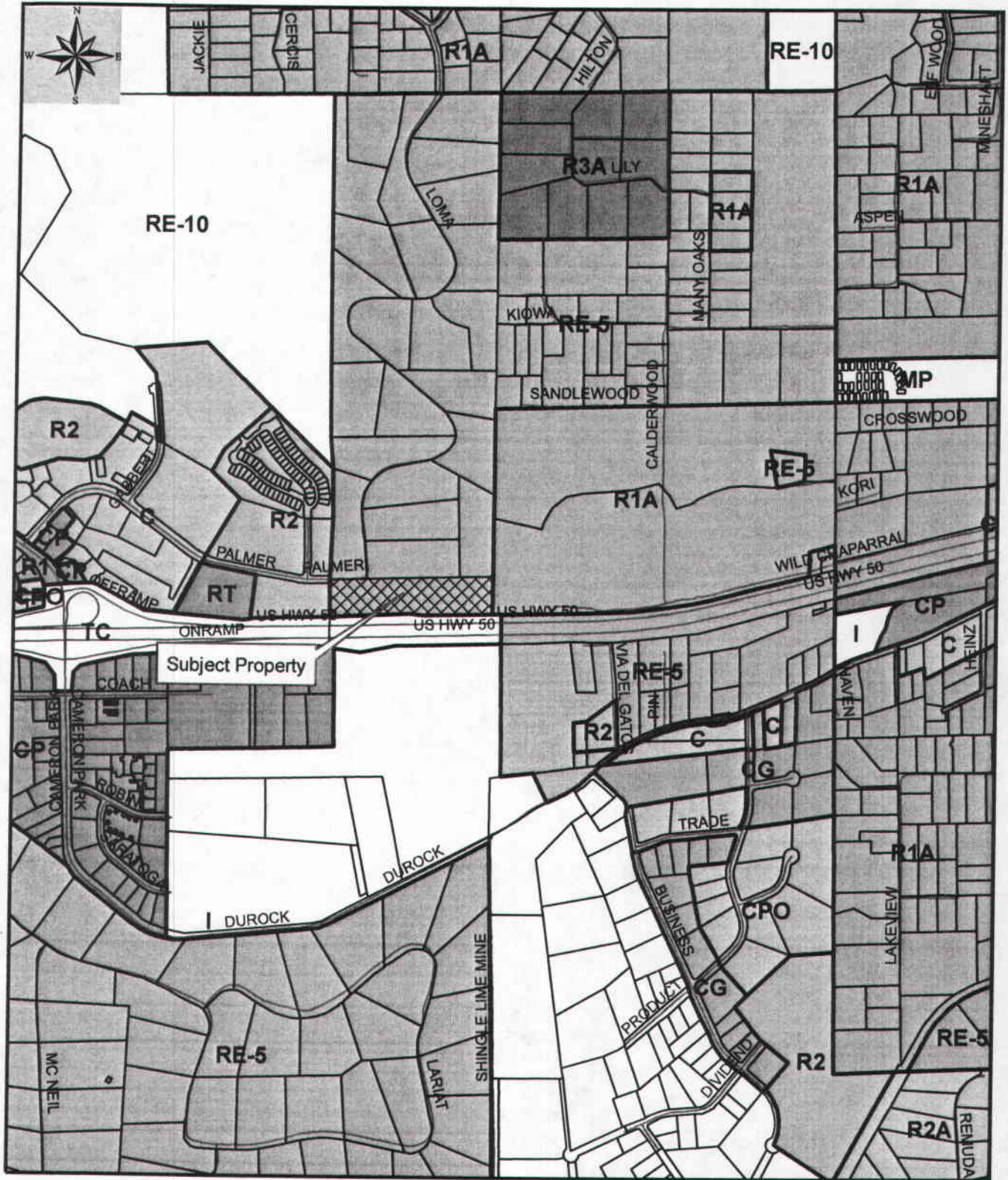

0 200 400 800 Feet

Map prepared by
M. P. Adams
11 Dorado County
Development Services/Harrington

Exhibit C- Zone Map

Findings of Consistency- Detmold Property Acquisition GOV10-0009

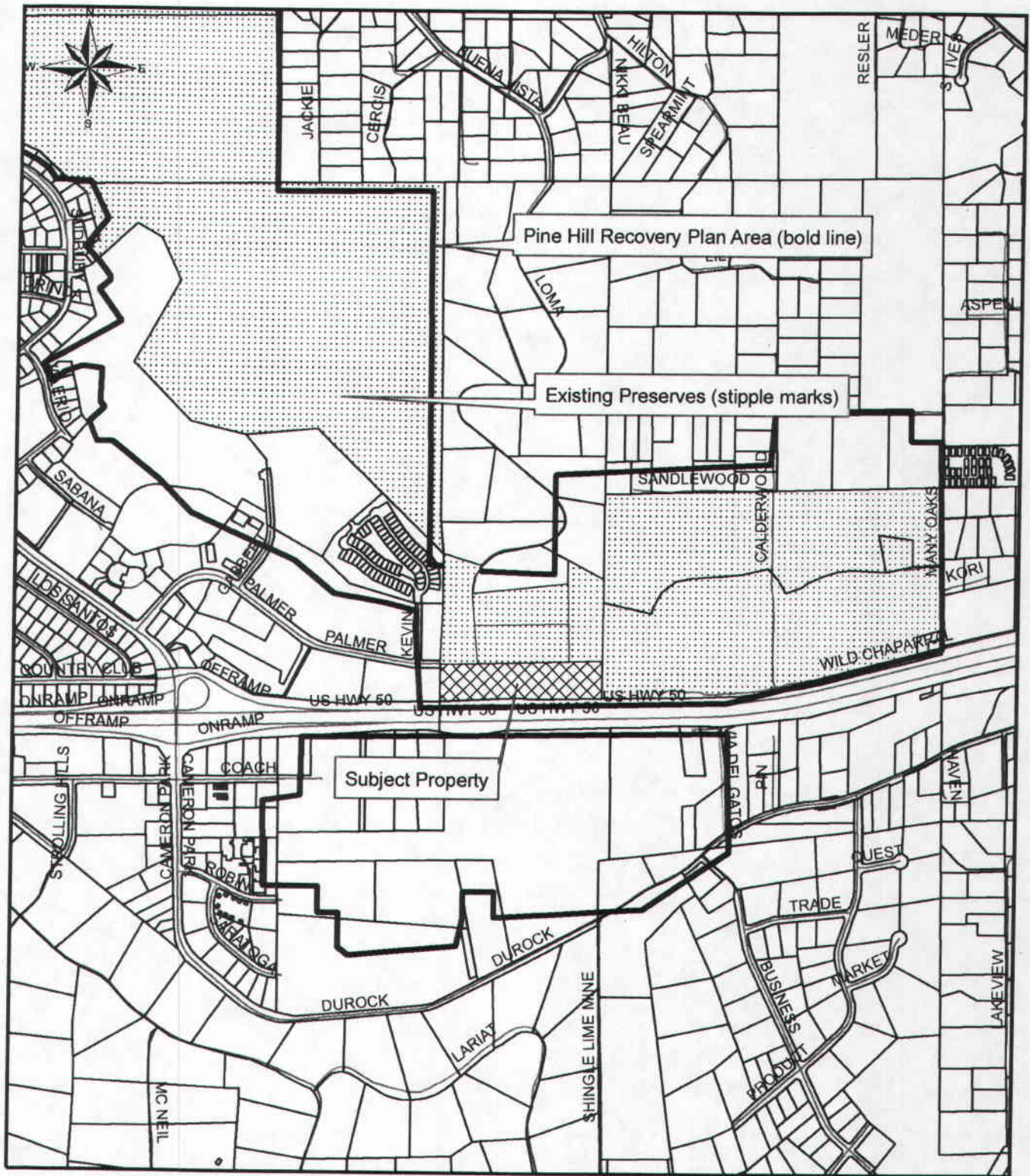

**Exhibit D- Existing Preserves Lands
and Recovery Plan Boundary**

0 205 410 820 Feet
Map prepared by
Mike Pashinski
II Dorado County
Development Services Planning