

EXHIBIT A: Location Map

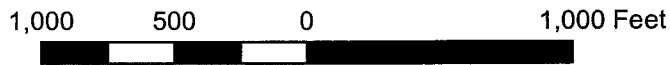
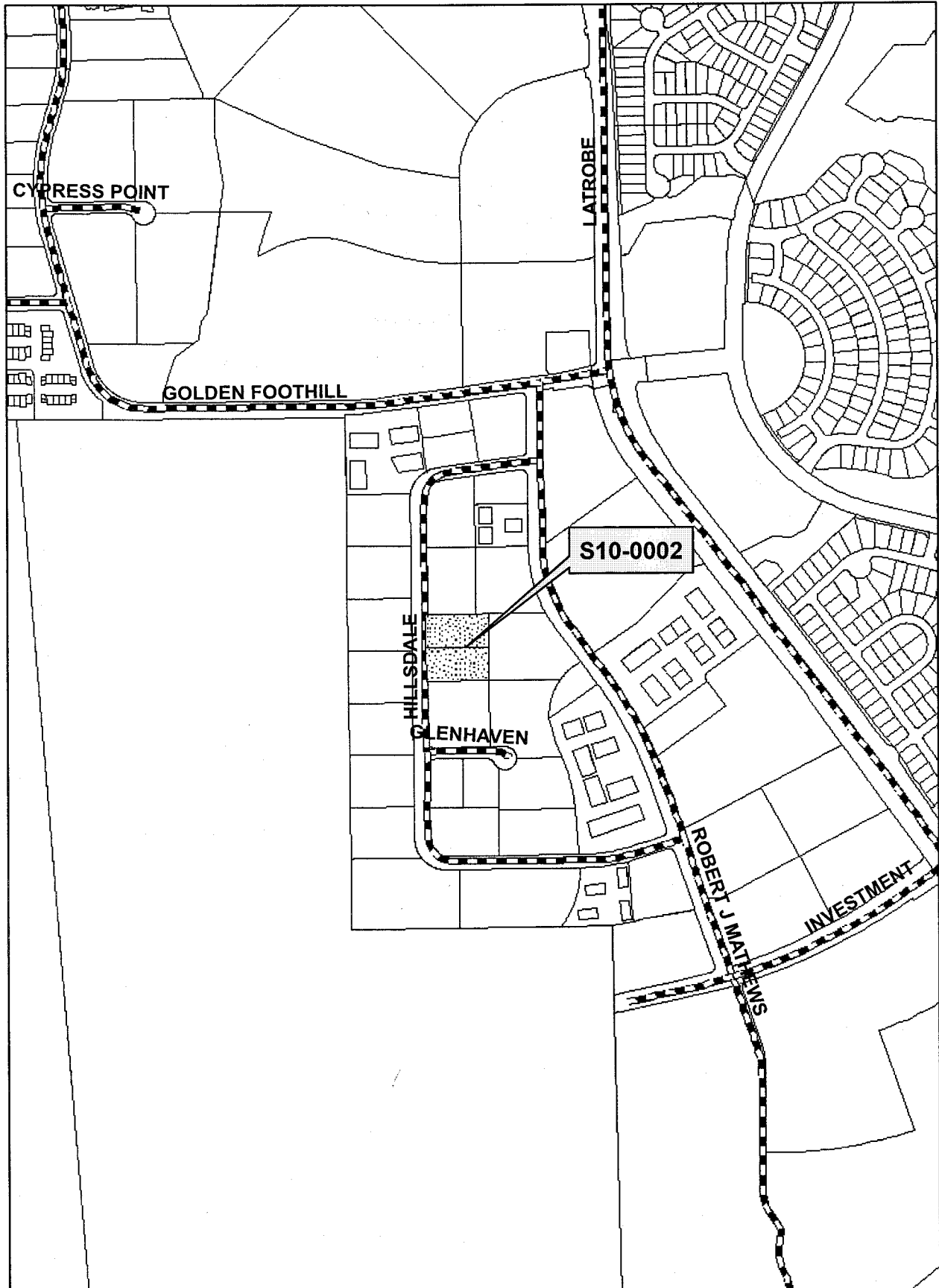

EXHIBIT C: General Plan Land Use Map

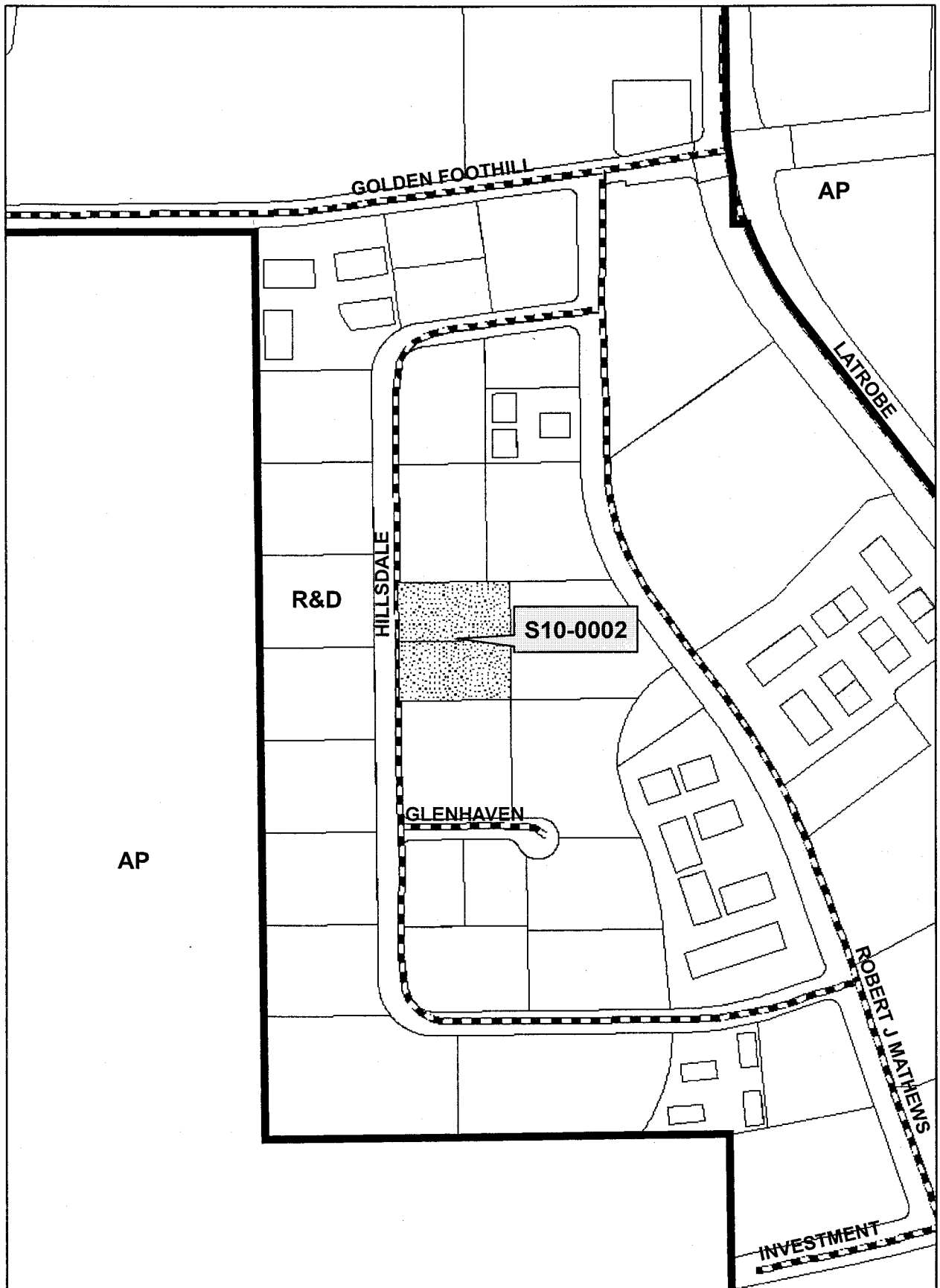
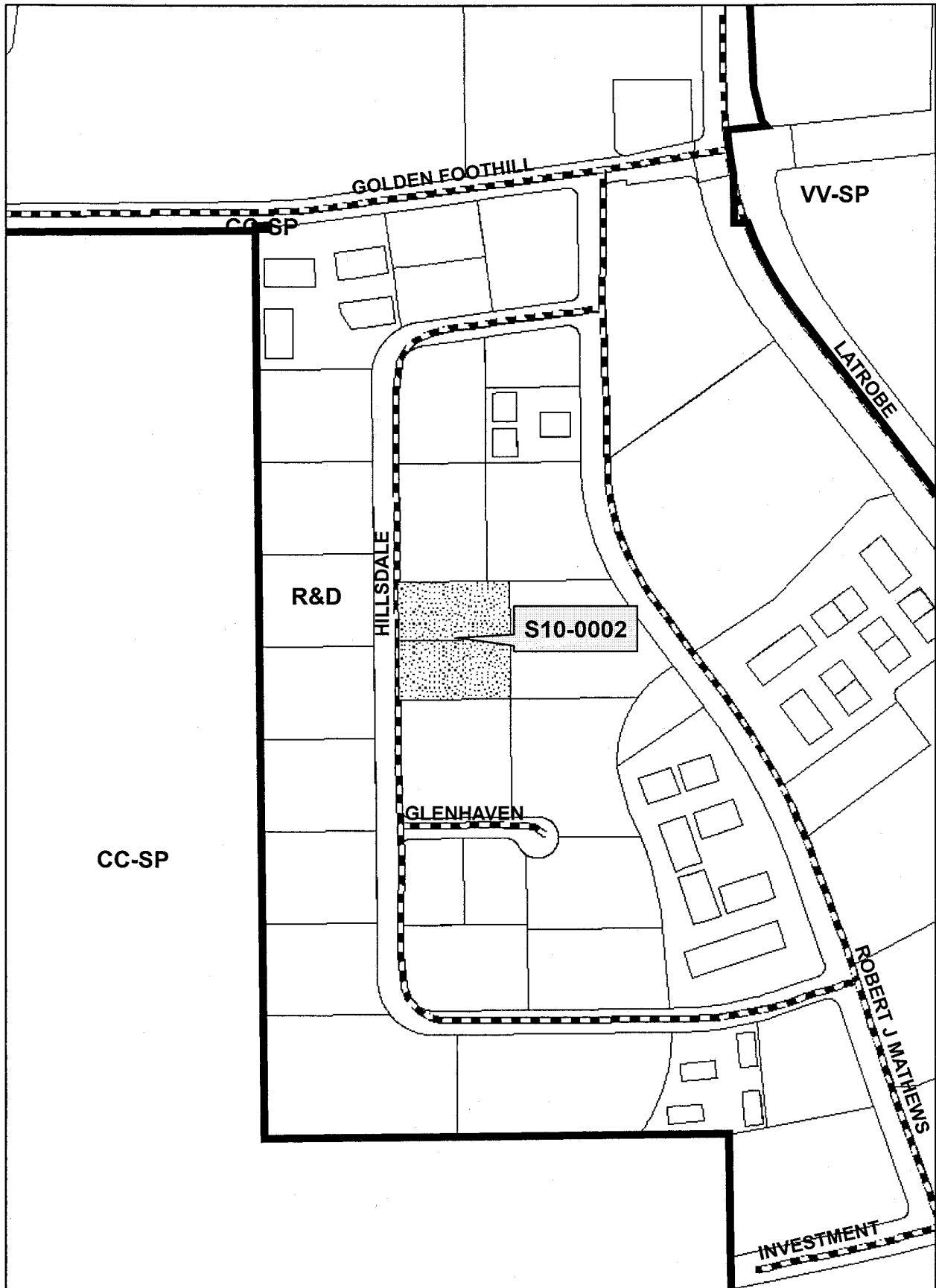

EXHIBIT D: Zoning Map



CC-SP

R&D

HILSDALE

GLENHAVEN

S10-0002

VV-SP

LATROBE

ROBERT J MATHIEWS

INVESTMENT

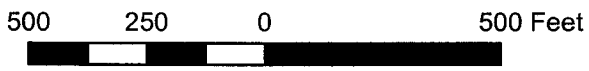
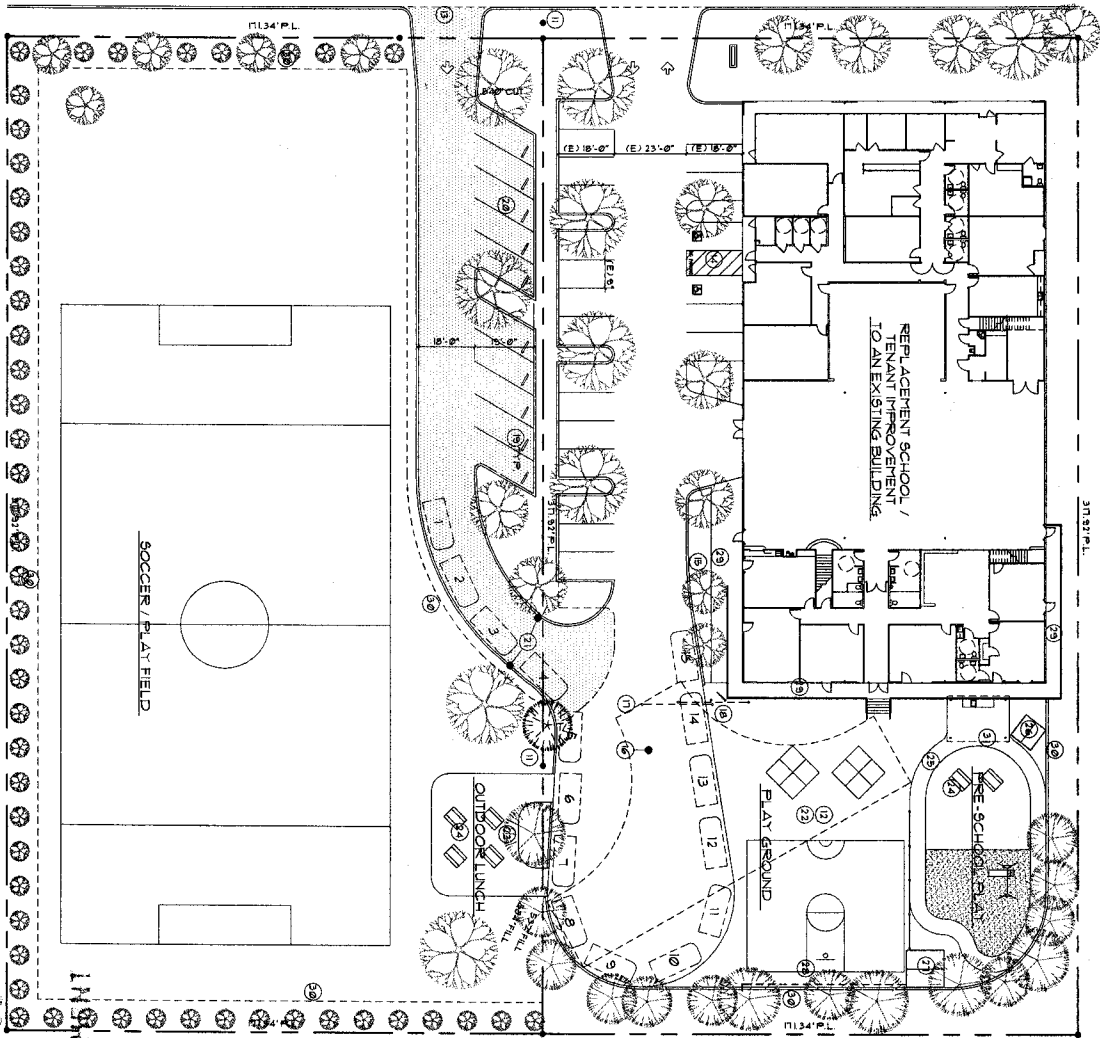

EXHIBIT E

HILLSDALE CIRCLE



PRELIMINARY OVERALL SITE PLAN
SCALE: 1" = 20'-0"

PROJECT INFORMATION

CODES: ALL CONSTRUCTION PERFORMED SHALL COMPLY WITH THE 2007 CBC, CBC, CFC & CEC, AS AMENDED BY THE STATE OF CALIFORNIA AND LOCAL JURISDICTION.

OWNER: MARBLE VALLEY SCHOOL, 5001 WINDFLAY DRIVE, SUITE 1, EL DORADO HILLS, CA 95762, 916.939.6519

SITE INFO: MARBLE VALLEY SCHOOL, 5005 HILLSDALE CIRCLE, EL DORADO HILLS, CA 95762, APN: 171-009-22 & 23

PROJECT SUMMARY:

OCCUPANCY: GROUP E-1
CONSTRUCTION: TYPE III-B, w/ AUTOMATIC SPRINKLER SYS.
PARCEL SIZE: (2) 1.25 ACRE PARCELS, 2.5 ACRES TOTAL
STORIES: ONE PLUS MEZZANINE
FIRST FLOOR SQ. FT.: 17,499
MEZZANINE SQ. FT.: 3,980
TOTAL SQ. FT.: 21,479
EXISTING PARKING: 25 (PROPOSED ELIMINATION OF 3)
PROPOSED NET PARKING: (25-3) = 10 = 32

SITE WORK NOTES / SCOPE:

DRAWING INDEX
A1 OVERALL SITE PLAN + PROJECT INFO
A2 PRELIM GRADING + LANDSCAPE PLAN

SITE WORK SCOPE FOR THIS PROJECT IS LIMITED TO FOLLOWING SITE IMPROVEMENTS:
REPLACE EXISTING SITE PLAY AND W/ NEW BOUND FOR PAUL, AERIAL, TRAMPOLINE, AND NEW BOUND FOR SHEDS AND STAGE SET.
REPLACE EXISTING SCHOOL, PL. GROUND STAIRS ON EXISTING ACCESSIBLE ENTRANCE WITH NEW PROPOSED CLIMBER ON ONTO ADDITIONAL AC PAVED PARKING (8 SPACES), 1 STOP OFF CIRCULATION, FURNITURE (ON ADJ. VACANT PARCEL, INSTALLATION OF NATURAL, TUFF MATS, ED. PL. PLANTING ON ADJ. VACANT PARCEL, INCLUDING VEGETATION REMOVAL, IRRIGATION + DRAINAGE SYSTEM.
FENCES (INTRODUCTION AS SHOWN).
ALL PLAYGROUND + BALL FIELDS SHALL HAVE A FENCE W/ W/ RETRIEVE W/ LANDSCAPE BARRIER.
LANDSCAPE BARRIER SHALL INCLUDE 8' TALL + 8' BARRIERS PER 10' BARRIER FINISH. 3' TALL OR 5' TALL OR 6' TALL AT STREET FRONT.

SHEET NOTES

- 1) FINE LITREANT
- 2) 12' X 12' HOLLOW AIR STORAGE SHED / BUILDING
- 3) PROPOSED CURB CUT
- 4) ACCESSIBLE PARKING + ACCESSIBLE
- 5) PROPOSED STUDENT DROP OFF
- 6) FIRE TRUCK HAZARD HEAD TURN DIAGRAM
- 7) VEHICLE GATE
- 8) PERSONNEL GATE
- 9) CONCRETE WHEEL STOP
- 10) DOTS INDICATE NEW AC PAVED PARKING 1 DRIVE ABLE
- 11) 6" CONCRETE CURB
- 12) TYPICAL ELEMENTARY SCHOOL
- 13) PLAYGROUND SPRING / PAINTED WOODEN PLAY
- 14) SIGNIC / OUTDOOR EATING LUNCH TABLES
- 15) SIGNING FOR PAVED PATH
- 16) 8' X 8' MODULAR STORAGE SHED / BUILDING
- 17) 12' X 12' HOLLOW AIR STORAGE SHED / BUILDING
- 18) PLAYGROUND BASEBALL STANDARDS
- 19) ACCESSIBLE RAMP-FRONT FINISH FLOOR OF SCHOOL TO PLAYGROUND
- 20) FENCING + PERIMETER OF OUTDOOR PLAY AREAS
- 21) WOOD PAINTED SHADE STRUCTURE

VICINITY MAP

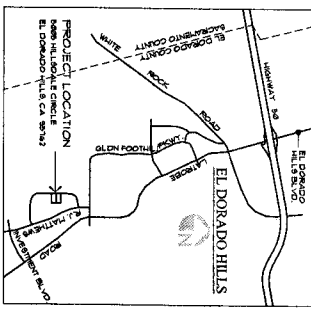

MARBLE VALLEY SCHOOL RELOCATION
5005 HILLSDALE CIRCLE
EL DORADO HILLS, CA 95762

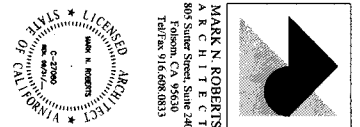

SITE PLAN & PROJECT INFORMATION
A1
Sheet 1 of 1

