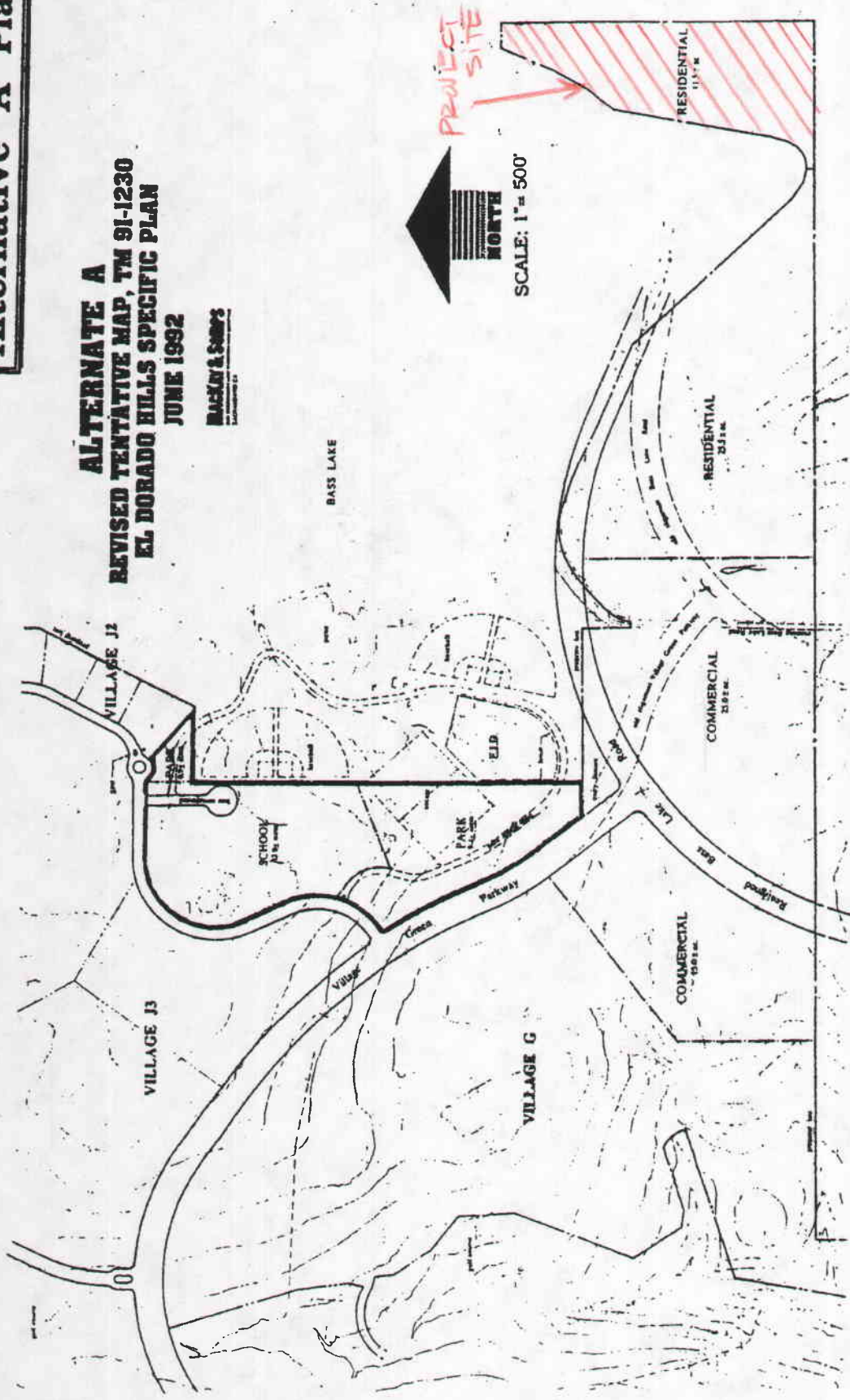

**Exhibit A**  
**Alternative A Plan**

**ALTERNATE A**  
**REVISED TENTATIVE MAP, TM 91-1230**  
**EL DORADO HILLS SPECIFIC PLAN**  
**JUNE 1992**  
**BLACKLEY & SONS**



**EXHIBIT F**

**FIGURE 3  
CONCEPTUAL REALIGNMENT OF BASS LAKE ROAD**

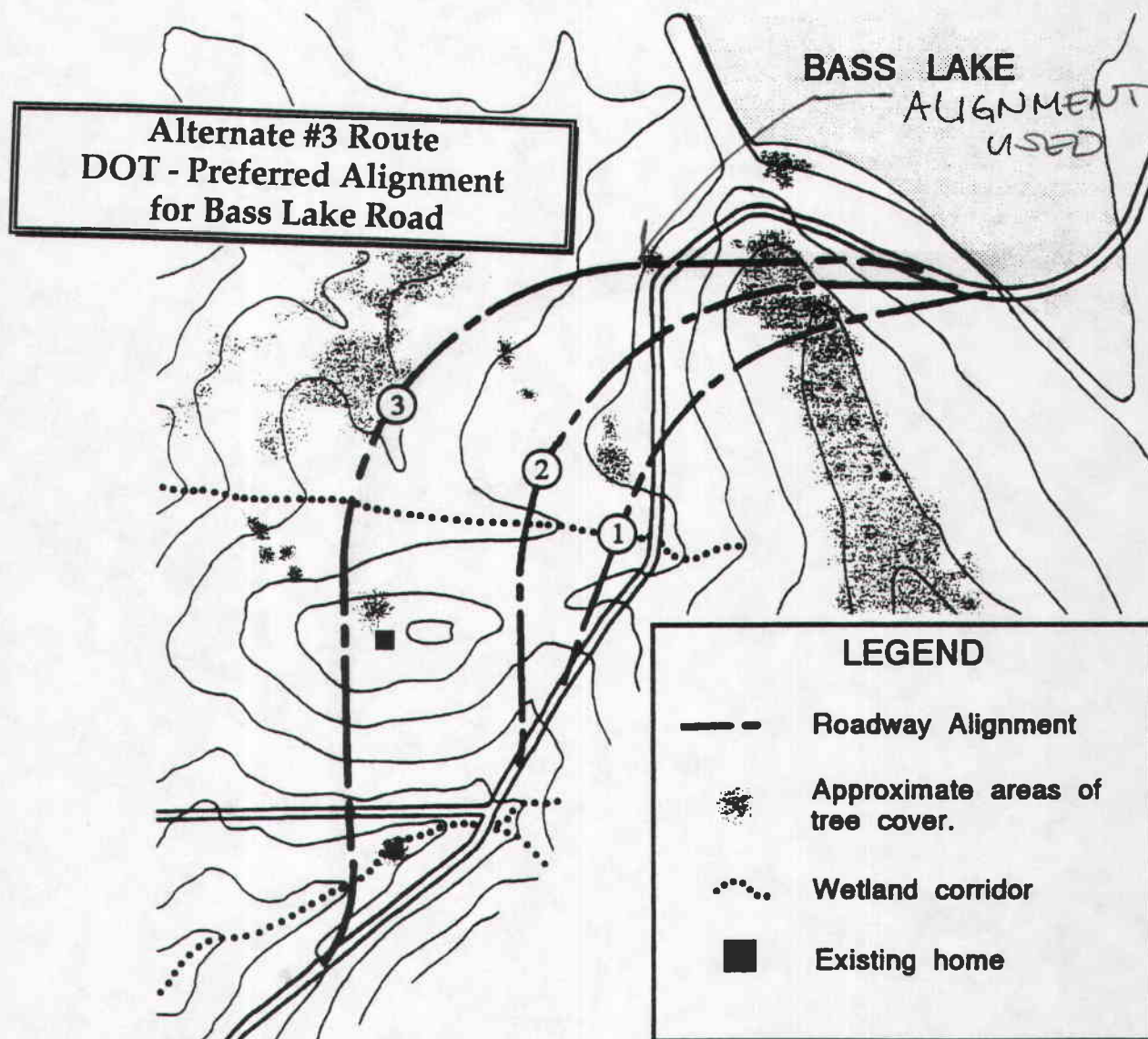

Without an adopted alignment, it is impossible to determine exactly how many trees will be impacted. In order to quantify this impact, R. C. Fuller Associates staff counted trees within a  $\pm 100$  foot wide corridor crossing the ridge along the approximate centerlines of the conceptual realignments. The number of trees impacted by either alignment would vary from 25-30 trees, virtually all of which are native oaks. Most of the trees range in size from 6" to 24" dbh. However, several trees are stately specimens with diameters larger than 36".