



DIST	COUNTY	ROUTE	KILOMETER POST TOTAL PROJECT	SHEET NO.	TOTAL SHEETS

**Randell D. Hiatt**  
REGISTERED CIVIL ENGINEER

June 6, 2008  
PLANS APPROVAL DATE

The State of California or its officers or agents shall not be responsible for the accuracy or completeness of electronic copies of this plan sheet.

To get to the Caltrans web site, go to: <http://www.dot.ca.gov>

To accompany plans dated \_\_\_\_\_

REGISTERED PROFESSIONAL ENGINEER  
Randell D. Hiatt  
No. C50200  
Exp. 6-30-09  
CIVIL  
STATE OF CALIFORNIA

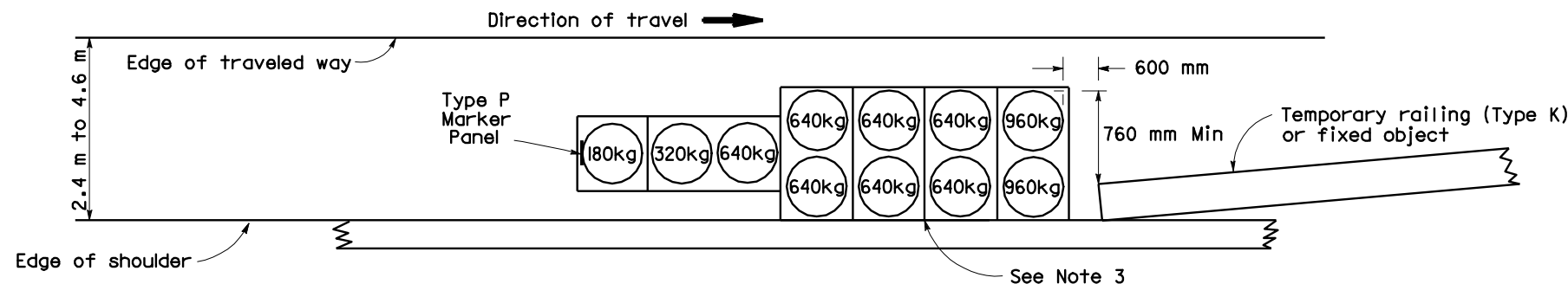

**ARRAY 'TSII'**

Approach speed less than 70 km/h  
See Note 9

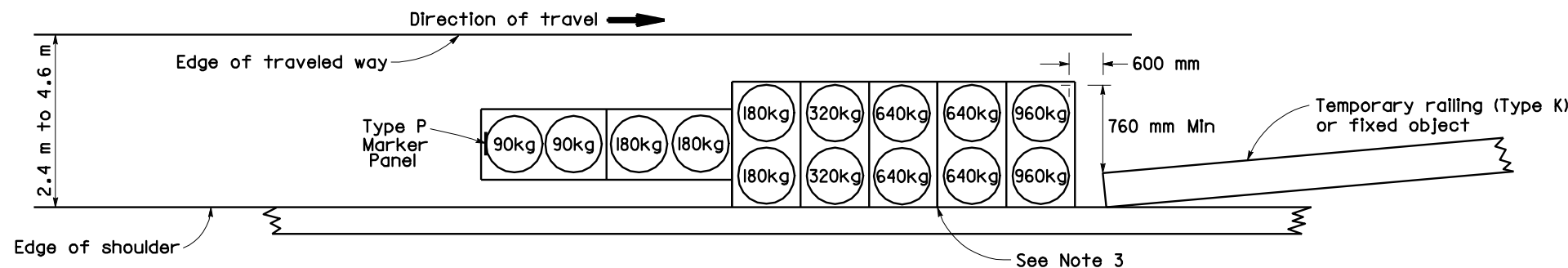

**ARRAY 'TSI4'**

Approach speed 70 km/h or more  
See Note 9

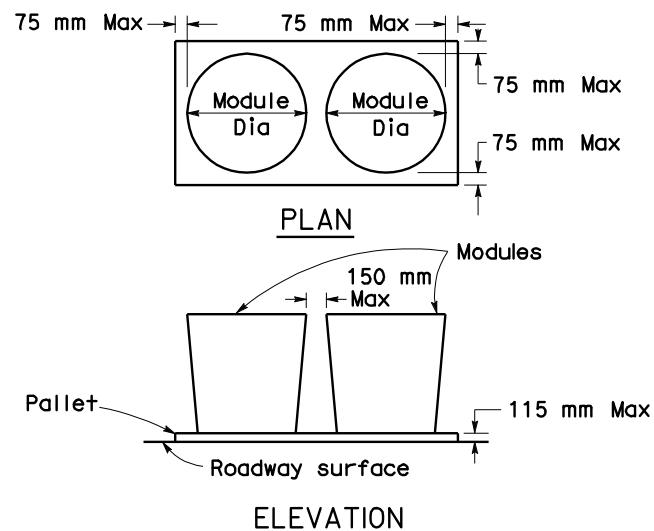

**CRASH CUSHION PALLET DETAIL**

See Note 11

**NOTES**

- (XXX) Indicates sand filled module location and mass of sand in kilograms for each module. Module spacing is based on the greater diameter of the module.
- All sand masses are nominal.
- The temporary crash cushion arrays shown on this plan shall be used only in locations where there will be traffic on one side of the temporary crash cushion array.
- If the fixed object or approach end of the temporary railing is less than 4.60 meters from the edge of traveled way, a temporary crash cushion is required.
- Temporary crash cushion arrays shall not encroach on the traveled way.
- Arrays for median shoulders shall conform to details shown on this plan for outside shoulders.
- Place the Type P marker panel so that the bottom of the panel rest upon the pallet and faces traffic.
- Refer to Standard Plan A73B for marker details.
- For shoulder widths less than 2.4 m, appropriate approved crash cushion protection, other than sand filled modules, shall be provided at fixed objects and at approach ends of temporary railing. The specific type of crash cushion shall be as shown on the project plans or as specified in the Special Provisions, or if not shown on the project plans or specified in the Special Provisions, shall be as approved by the Engineer.
- Approach speeds indicated conform to NCHRP 350 Report criteria.
- Use of Pallets is optional.

STATE OF CALIFORNIA  
DEPARTMENT OF TRANSPORTATION

**TEMPORARY CRASH CUSHION,  
SAND FILLED  
(SHOULDER INSTALLATIONS)**

NO SCALE  
ALL DIMENSIONS ARE IN  
MILLIMETERS UNLESS OTHERWISE SHOWN

RSP T2 DATED JUNE 6, 2008 SUPERSEDES STANDARD PLAN T2  
DATED July 1, 2004 - PAGE 213 OF THE STANDARD PLANS BOOK DATED July 2004.

**REVISED STANDARD PLAN RSP T2**

2004 REVISED STD PLAN RSP T2

213